



Electro-Shear™ Brakes for Crane Applications
(For New and Retrofit Applications)

APPLICATION DATA SHEET

CRANE MANUFACTURER: BRAKE LOCATION: [] HOIST [] BRIDGE [] TROLLEY

WHAT IS THE VOLTAGE OF THE CRANE?: [] 200V [] 230V [] 460V [] 575V DOES CRANE USE A LOAD BRAKE?: [] YES [] NO

DOES APPLICATION ALREADY USE A BRAKE? [] YES [] NO

IF YES:

BRAKE MANUFACTURER: BRAKE MODEL NUMBER:

BRAKE SERIAL NUMBER: BRAKE TORQUE:

BRAKE MOUNTING POSITION: [] HORIZONTAL [] VERTICAL

IS BRAKE MOUNTED ON A MOTOR?: [] YES [] NO

IF YES:

MOTOR MANUFACTURER: MOTOR FRAME (INCLUDE LETTERS):

MOTOR HORSEPOWER: MOTOR R.P.M.:

MOTOR MODEL NUMBER:

DOES MOTOR FACE HAVE C-FACE ON OPPOSITE TO THE DRIVE END?: [] YES [] NO

IS BRAKE MOUNTED ON A GEAR BOX?: [] YES [] NO

IF YES:

WHAT TYPE OF GEAR BOX? (CHECK ONE): [] D3 [] D8 [] D11 [] OTHER

OTHER MOUNTING INFORMATION:

WHAT IS THE MOUNTING BOLT CIRCLE? (SEE FIG.3): WHAT IS THE BOLT SIZE? (SEE FIG.3):

WHAT IS THE SHAFT DIAMETER? (SEE FIG.2): DOES THE SHAFT HAVE STEPS ON IT? (SEE FIG.2):

DOES THE SHAFT EXTEND THRU THE BRAKE?: WHAT IS THE KEYWAY SIZE? (SEE FIG.2):

IF BRAKE IS MOUNTED TO SPLINE SHAFT WHAT IS THE NUMBER OF TEETH? (SAMPLE HUB OR SHAFT REQUIRED FOR MEASUREMENT):

WHAT IS THE LENGTH OF THE SHAFT EXTENSION FROM THE MOUNTING SURFACE? (SEE FIG.2):

WILL ANY PART OF THE APPLICATION LIMIT OR INTERFERE WITH AN ELECTRO-SHEAR APPLICATION?:

MIDWEST BRAKE™ • 26255 Groesbeck Hwy. • Warren, MI 48089 • 586.775.3000 Fax: 586.775.3040
• Internet: www.midwestbrake.com • E-mail: sales@midwestbrake.com

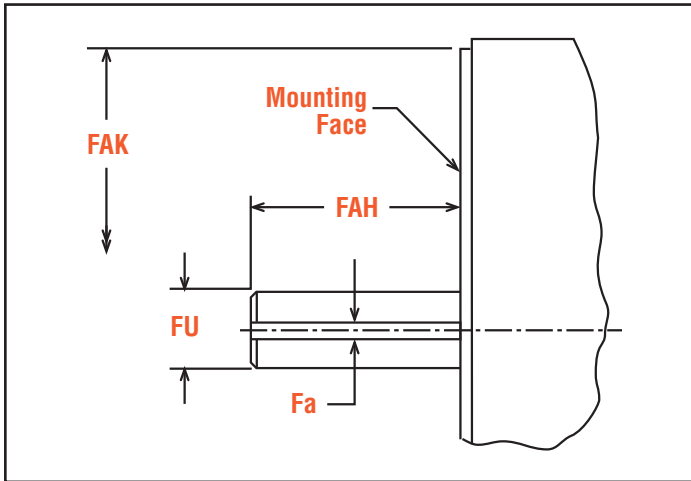

Figure 1

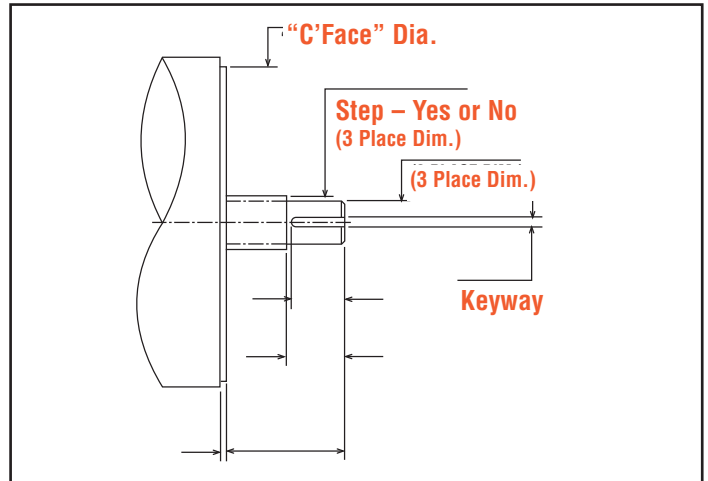

Figure 2

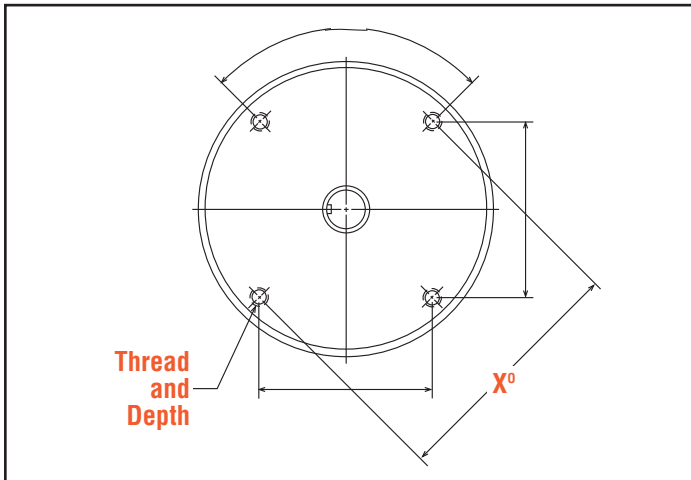

Figure 3

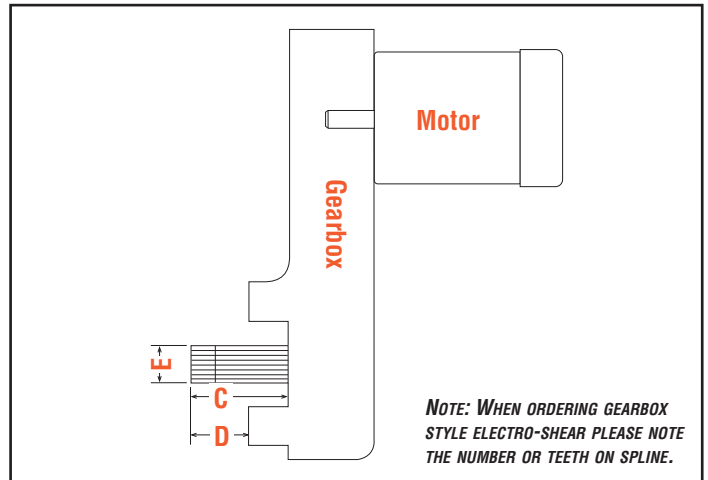

Figure 4

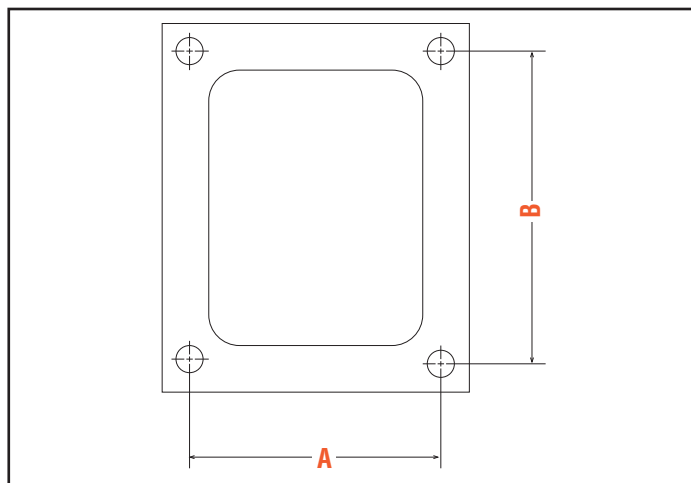

Figure 5

CUSTOMER NOTES AND COMMENTS:
