

Authorized Distributor



26255 Groesbeck Hwy.  
Warren, MI 48089 U.S.A.  
586.775.3000 • 586.775.3040 (Fax)  
sales@midwestbrake.com  
www.midwestbrake.com

Eaton® Airflex® Clutches & Brakes

## 4.0 PARTS LIST

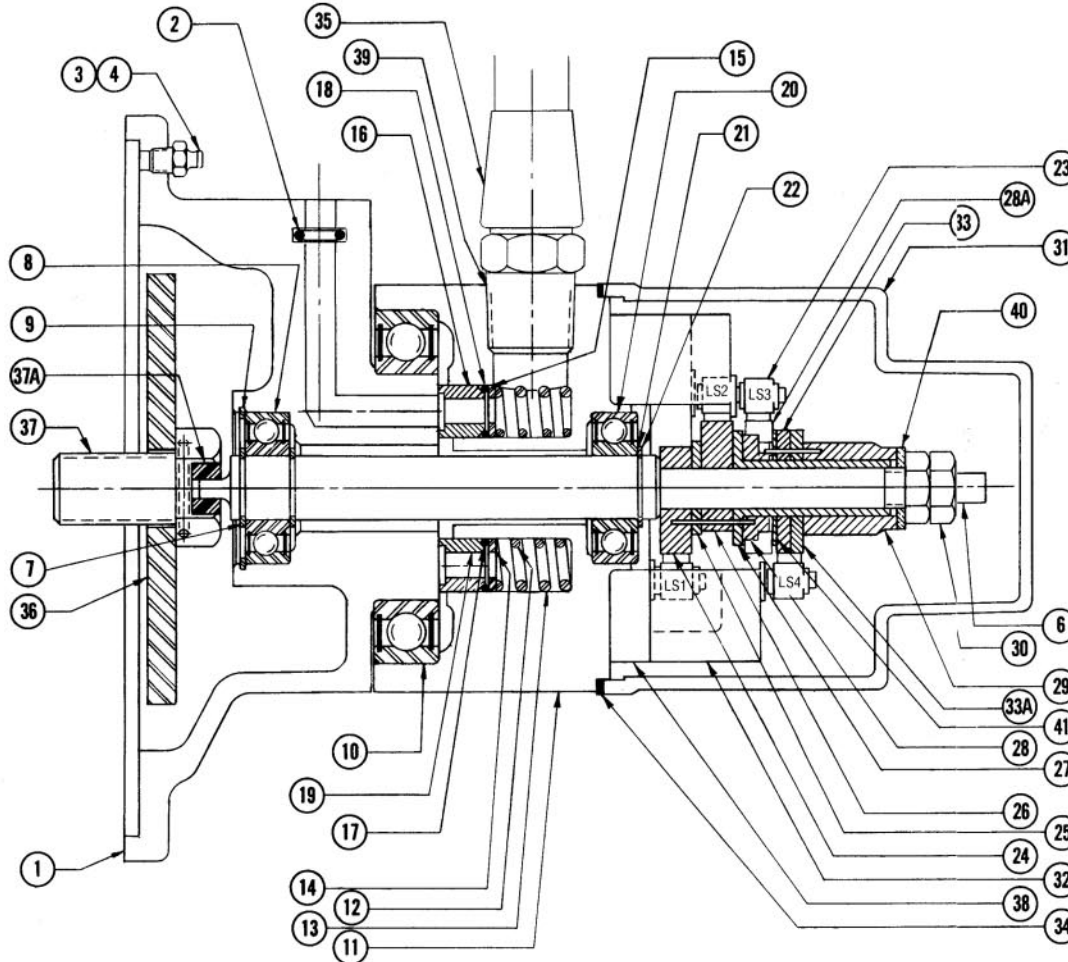

TIMING ROTORSEAL

Part No. for Optional Cam No. 3 (Item No. 28A), is as follows:  
203002 (For clockwise and clockwise 30° dwell)  
203087 (for c'lockwise and c'lockwise 30° dwell)

Item No.	Part No.	Description	No. Req.	Item No.	Part No.	Description	No. Req.
1.	See table A	Adapter	1	22.	139 x 12	Snap ring	1
2.	See table A	"O" ring	—	23.	See table B	Breaker points	4
3.	145 x 30	Relief fitting	1	24.	See table B	No. 1 cam	1
4.	145 x 2	Grease fitting	1	25.	201854	Washer	1
6.	304123	Shaft	1	26.	See table B	No. 2 cam	1
7.	139 x 12	Snap ring	2	27.	201869	Cam adjusting sleeve	1
8.	159 x 57	Bearing	1	28.	See table B	No. 3 cam insert	1
9.	138 x 10	Snap ring	1	28A.	306030	No. 3 cam	1
10.	159 x 40	Bearing	1	29.	203003	Cam adjusting knob	1
11.	403957	Center section	1	30.	61 x 22	Jam nut	2
12.	201695	Inner spring	1	31.	412230	End cap	1
13.	201677	Outer spring	1	32.	409346	Bridge	1
14.	201693	Inner washer	1	33.	See table B	No. 4 cam	1
15.	201694	Outer washer	1	33A.	See table B	No. 5 cam	1
16.	301965	Outer seal	1	34.	119 x 23	Felt seal	1
17.	73 x 133	Inner "O" ring	1	35.	See table A.	Air hose	1
18.	73 x 134	Outer "O" ring	1	36.	See table A	End plate	1
19.	201686	Inner seal	1	37.	305468	Drive screw	1
20.	159 x 57	Bearing	1	37A.	203333	Drive screw insert	1
21.	144 x 46*	Shim set	1	38.	507137	Mounting plate	1
				39.	303 x 1**	Flush pipe bushing	1
				40.	153 x 530	Flat washer	1
				41.	203107	Spacer	1

\*Use as necessary.

\*\*Used on Timing Rotorseals for FSPA's 01 thru 114.

The part no. for the complete assembly is stamped on the timer decal. Identify the timer with this number when specifying component parts.

TABLE A

FSPA No.	Part No.				
	Item No. 1 Adapter	Item No. 2 "O" Ring	Item No. 35 Qty.	Item No. 36 Air Hose	Item No. 37 End Plate
01	408441	73 x 89	2	318 x 2	410743-30
1,2,103,104,105	408441	73 x 89	2	318 x 2	410743-1
6,7,8	412842	73 x 89	4	318 x 2	410743-60
109,110,111	412842	73 x 89	4	318 x 2	410743-2
112,113,114	509852	73 x 89	4	318 x 2	410743-3
115,116,117	509853	73 x 15	4	318 x 4	410743-3
118,119,120,121,122	505382	73 x 15	4	318 x 4	410743-11

TABLE B

509625 Complete Assembly Part No. Used On:							Direction of Rotation	Part Number <sup>1</sup>					
FSPA 01	FSPA 1,2,103,104,105	FSPA 6,7,8	FSPA 109,110,111	FSPA 112,113,114	FSPA 115,116,117	FSPA 118,119,120,121,122		Item No. 23 Breaker Points	Item No. 24 No. 1 Cam	Item No. 26 No. 2 Cam	Item No. 28 No. 3 Cam Insert	Item No. 33 No. 4 Cam	Item No. 33A No. 5 Cam
145744 GX	145744 GK	145744 HB	145744GP	145744 GT	145744 HF	145744 HK	Clockwise	133 x 201	201856	201857	306029	203256	203257
145744 GY	145744 GL	145744 HC	145744GQ	145744 GU	145744 HG	145744 HL	C'Clockwise	133 x 200	201858	201859	306028	203254	203255
145744 GZ	145744 GM	145744 HD	145744GR	145744 GV	145744 HH	145744 HM	Clockwise 30° Dwell	133 x 201	201861	201862	306029	203256	203257
145744 HA	145744 GN	145744 HE	145744GS	145744 GW	145744 HJ	145744 HN	C'Clockwise 30° Dwell	133 x 200	201863	201864	306028	203254	203255